

COMMON

- Added accessories can affect a motorcycle's stability, performance and safe riding speed.

ACCESSORY SOCKET

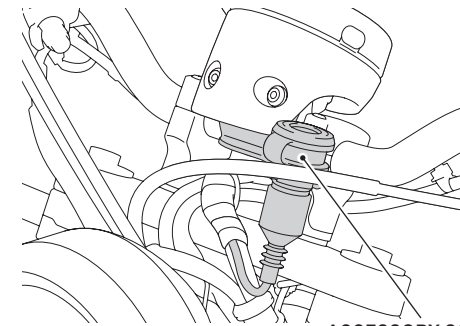

ACCESSORY SOCKET

CENTER TANK PAD

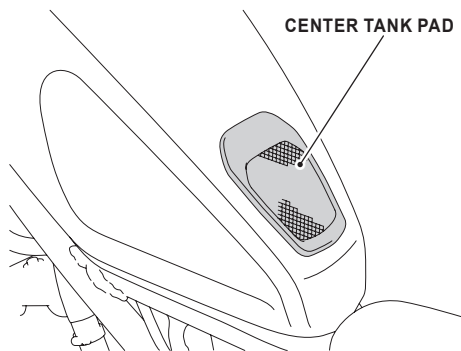

- Check the accessory mounts frequently.
- Clean this accessory with a soft cloth soaked with a solution of mild detergent and water. Then wipe with a clean cloth soaked with water to clean dirt and detergent. Finally wipe dry with a soft, clean cloth.

- The maximum power rating of connected accessories is 12W (12V, 3A).
- Use accessories with the engine running to avoid discharging the battery.
- Do not use a cigarette lighter, as this can cause a malfunction.
- Cover the socket with the cap when the accessory socket is not used to prevent entry of foreign objects.
- Carefully secure any connected devices, as vibrations may cause them to shift unexpectedly.
- Do not use the accessory socket when the motorcycle is being washed.
- Make sure that the cable of device connected to the accessory socket does not disturb the steering operation or riding. Do not pinch the cable to prevent from being damaged.
- Check the accessory mounts frequently and retighten if necessary.
- Clean this accessory with a soft cloth soaked with a solution of mild detergent and water. Then wipe with a clean cloth soaked with water to clean dirt and detergent. Finally wipe dry with a soft, clean cloth.

SIDE TANK PAD

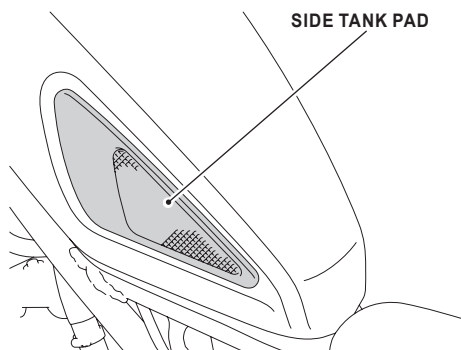

- Check the accessory mounts frequently.
- Clean this accessory with a soft cloth soaked with a solution of mild detergent and water. Then wipe with a clean cloth soaked with water to clean dirt and detergent. Finally wipe dry with a soft, clean cloth.

FRONT FORK BOOT

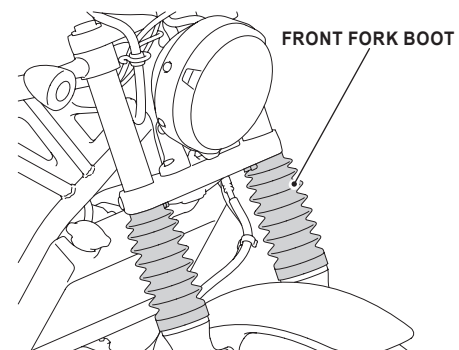

- Check the accessory mounts frequently and retighten if necessary.
- Clean this accessory with a soft cloth soaked with a solution of mild detergent and water. Then wipe with a clean cloth soaked with water to clean dirt and detergent. Finally wipe dry with a soft, clean cloth.

CMX300/A, CMX500/A

Genuine Accessory User's Guide

FRONT FORK COVER

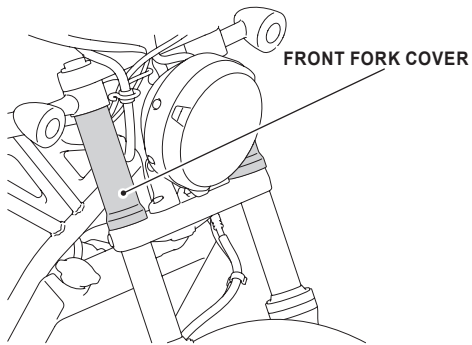

- Check the accessory mounts frequently.
- Clean this accessory with a soft cloth soaked with a solution of mild detergent and water. Then wipe with a clean cloth soaked with water to clean dirt and detergent. Finally wipe dry with a soft, clean cloth.

MAIN SEAT

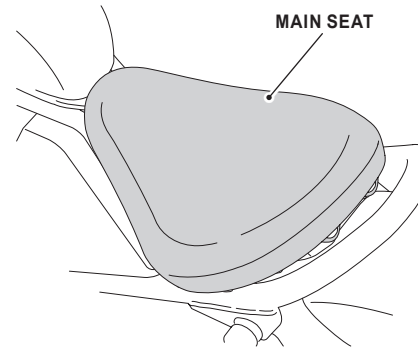

- Check the accessory mounts frequently.
- Clean this accessory with a soft cloth soaked with a solution of mild detergent and water. Then wipe with a clean cloth soaked with water to clean dirt and detergent. Finally wipe dry with a soft, clean cloth.

RIGHT HANDLE LEVER ASSEMBLY

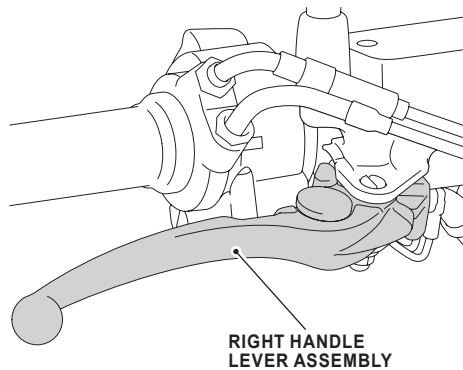

- Check the accessory mounts frequently.
- Clean this accessory with a soft cloth soaked with a solution of mild detergent and water. Then wipe with a clean cloth soaked with water to clean dirt and detergent. Finally wipe dry with a soft, clean cloth.

PASSENGER SEAT

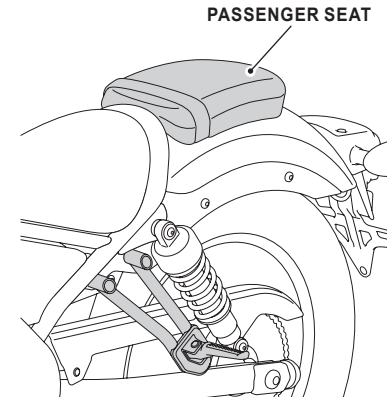

- Check the accessory mounts frequently and retighten if necessary.
- Clean this accessory with a soft cloth soaked with a solution of mild detergent and water. Then wipe with a clean cloth soaked with water to clean dirt and detergent. Finally wipe dry with a soft, clean cloth.

ADJUSTING METHOD

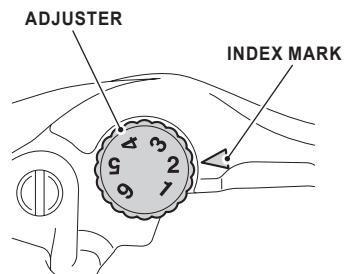

1. Turn the adjuster until the numbers align with the index mark while pushing the lever forward in the desired position.
 - **After adjustment, check that the lever operates correctly before riding.**

CMX300/A, CMX500/A

Genuine Accessory User's Guide

METER VISOR

METER VISOR

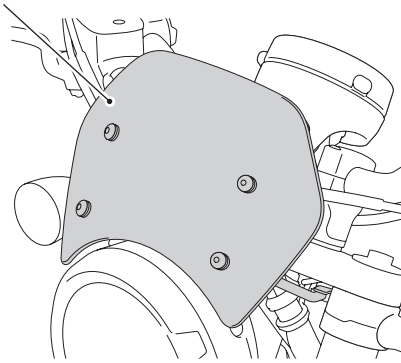

- Handle this accessory with care. It can be damaged when it is bent excessively or is subject to strong shock or impact.
- Park the motorcycle in the shade when it is to be left unattended in the summer for an extended period of time with a body cover placed over it.
- Failure to observe this precaution can cause this accessory to be deformed due to heat built up under the body cover.
- Select a firm, level surface when you park the motorcycle. Also bear in mind that strong wind can cause the motorcycle to topple to the ground.
- Check the accessory mounts frequently and retighten if necessary.
- When this accessory becomes dirty, rinse it thoroughly with cool water to remove loose dirt, then wipe with a clean cloth or sponge. Do not use a brush to clean this accessory as it may scratch the surface.
- Never use organic solvents such as gasoline, thinner or benzene to clean this accessory. Also do not use acid or alkaline cleaners.
- Wipe up spilled brake fluid at once as it may damage the plastic surface.

HEADLIGHT COWL

HEADLIGHT COWL

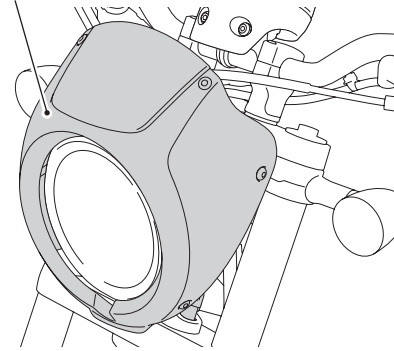

- Handle this accessory with care. It can be damaged when it is bent excessively or is subject to strong shock or impact.
- Park the motorcycle in the shade when it is to be left unattended in the summer for an extended period of time with a body cover placed over it.
- Failure to observe this precaution can cause this accessory to be deformed due to heat built up under the body cover.
- Select a firm, level surface when you park the motorcycle. Also bear in mind that strong wind can cause the motorcycle to topple to the ground.
- Check the accessory mounts frequently and retighten if necessary.
- When this accessory becomes dirty, rinse it thoroughly with cool water to remove loose dirt, then wipe with a clean cloth or sponge. Do not use a brush to clean this accessory as it may scratch the surface.
- Never use organic solvents such as gasoline, thinner or benzene to clean this accessory. Also do not use acid or alkaline cleaners.
- Wipe up spilled brake fluid at once as it may damage the plastic surface.

REAR CARRIER

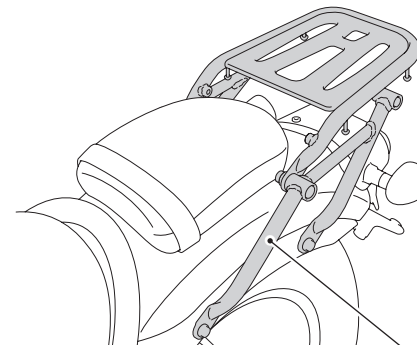

REAR CARRIER

- The weight of the cargo must not exceed the following maximum loading capacity:
3.0 kg (6.6 lb)
- Check the accessory mounts frequently and retighten if necessary.
- Never use organic solvents such as gasoline, thinner or benzene to clean this accessory. Also do not use acid or alkaline cleaners.
- Clean this accessory with a soft cloth soaked with a solution of mild detergent and water. Then wipe with a clean cloth soaked with water to clean dirt and detergent. Finally wipe dry with a soft, clean cloth.

CMX300/A, CMX500/A

Genuine Accessory User's Guide

BACKREST

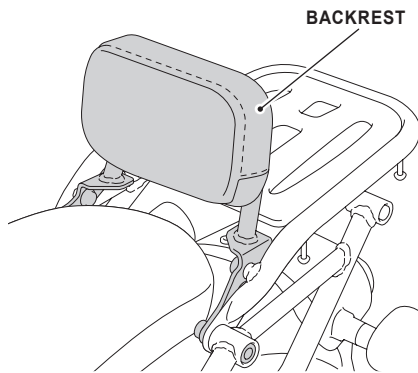

- Check the accessory mounts frequently and retighten if necessary.
- Never use organic solvents such as gasoline, thinner or benzene to clean this accessory. Also do not use acid or alkaline cleaners.
- Clean this accessory with a soft cloth soaked with a solution of mild detergent and water. Then wipe with a clean cloth soaked with water to clean dirt and detergent. Finally wipe dry with a soft, clean cloth.

SADDLEBAG SUPPORT

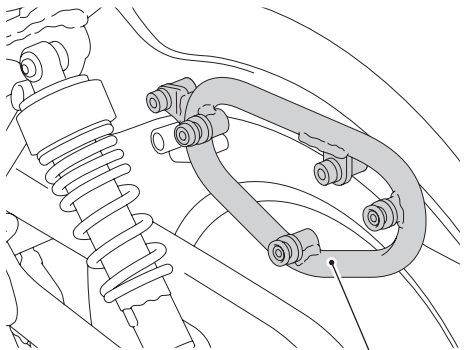

SADDLEBAG SUPPORT

- Check the accessory mounts frequently and retighten if necessary.
- Never use organic solvents such as gasoline, thinner or benzene to clean this accessory. Also do not use acid or alkaline cleaners.
- Clean this accessory with a soft cloth soaked with a solution of mild detergent and water. Then wipe with a clean cloth soaked with water to clean dirt and detergent. Finally wipe dry with a soft, clean cloth.

SADDLEBAG

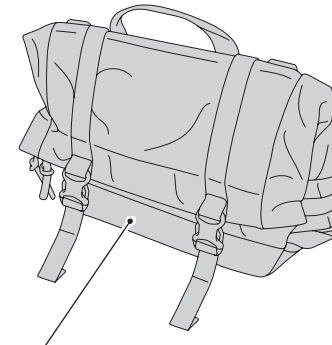

LEFT SADDLEBAG

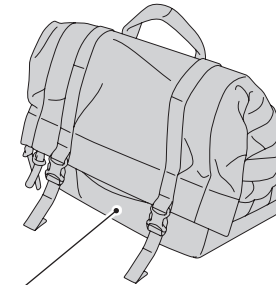

RIGHT SADDLEBAG

- The weight of the cargo must not exceed the following maximum loading capacity:

Left saddlebag	3.0 kg (6.6 lb)
Right saddlebag	3.0 kg (6.6 lb)

- Check that saddle bags and straps do not interfere with the motorcycle body. Pay special attention to hot parts and rotating parts.
- Check that the fastener is closed and the strap is tightened before riding.
- The inner bag is made of a material that is resistant to water from the outside, but is not completely waterproof due to its structure. There is a possibility of internal condensation or inundation due to the influence of heat while riding, running in the rain for a long time, or motorcycle washing.
- Due to the nature of the inner bag, do not store dangerous items, sharp objects, protrusions, or valuables.
- Check the accessory mounts frequently.
- Clean this accessory with a soft cloth soaked with a solution of mild detergent and water or a cleaner.
- If this accessory becomes completely wet (water has soaked through the material), remove this accessory and allow it to air dried at room temperature. Never dry this accessory in a dryer, in front of a heater, or near a fireplace.

CMX300/A, CMX500/A

Genuine Accessory User's Guide

SHOULDER STRAP

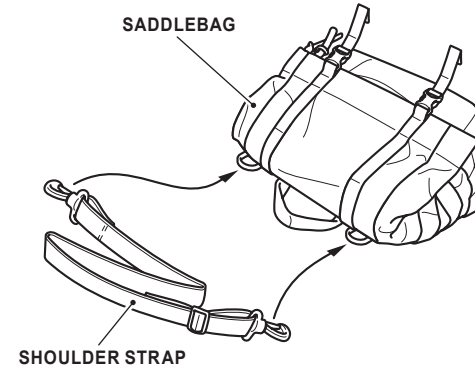

HOW TO USE THE SHOULDER STRAP

1. Hook the shoulder strap as shown.
 - Always store the shoulder strap when not in use.
 - Use the shoulder strap when carrying the saddlebag.

HOW TO INSTALL THE SADDLEBAG

1. Install the left saddlebag as shown.
 - Repeat on the right side.

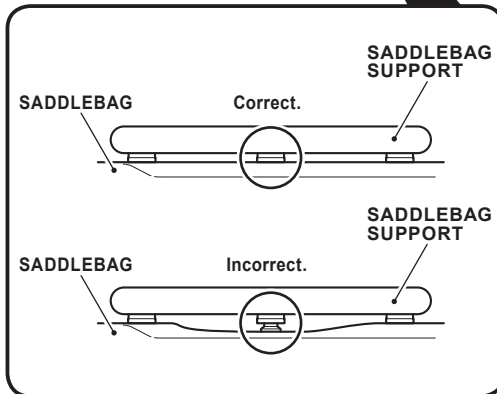
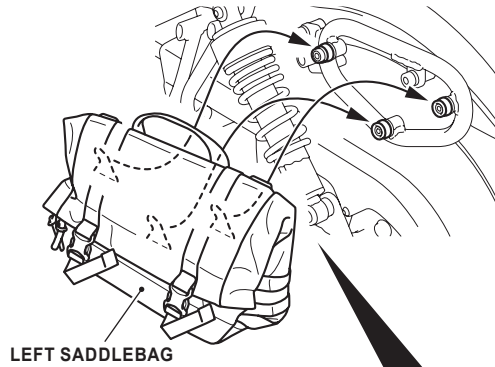

HOW TO REMOVE THE SADDLEBAG

1. Lower the lever as shown and remove the left saddlebag.
 - Repeat on the right side.

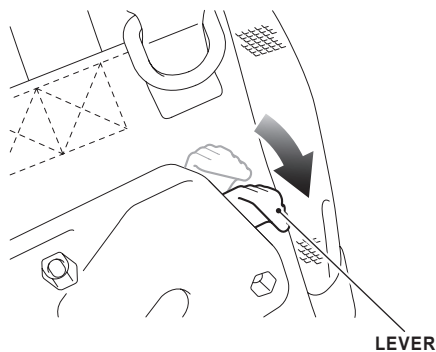

CMX300/A, CMX500/A

Genuine Accessory User's Guide

SAFETY INFORMATION

The following sentences show the label meaning.
Some labels warn you of potential hazards that could cause serious injury.
Others provide important safety information.
Read this information carefully and don't remove the label.

If a label comes off or becomes hard to read, contact your Honda dealer for a replacement.

There is a specific symbol on each label. The meanings of each symbol and label are as follows.



Read the use and care information in installation instructions or genuine accessory user's guide carefully.
Read the LOAD LIMITS AND GUIDELINES, and TYRES sections in owner's manual.



DANGER (with RED background)

You WILL be KILLED or SERIOUSLY HURT if you don't follow instructions.

WARNING (with ORANGE background)

You CAN be KILLED or SERIOUSLY HURT if you don't follow instructions.

CAUTION (with YELLOW background)

You CAN be HURT if you don't follow instructions.

Refer to this information for the meanings of the symbols shown on the accessory.

CARRIER WARNING LABEL



Regarding the maximum loading capacity.
Read the use and care information carefully in each of the accessory installation instructions or genuine accessory user's guide.