



INSTALLATION INSTRUCTIONS

Accessory
**RIGHT HANDLE
 LEVER ASSEMBLY**
 P/N 08U70-K87-A30

Application
**CMX300/A
 CMX500/A**

Publication No.
M11
 Issue Date
April 2020

Honda Dealer: Please give a copy of these instructions to your customer.

PARTS LIST

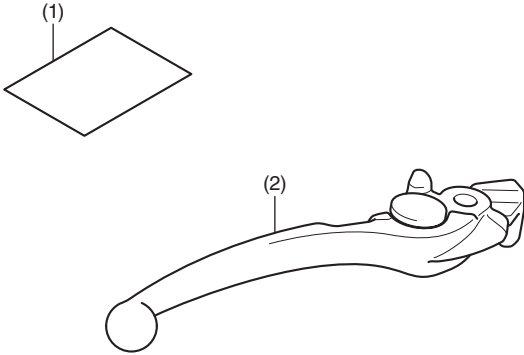

No.	Description	Qty
(1)	URL paper	1
(2)	Right handle lever assembly	1

TORQUE INFORMATION

Refer to the Service Manual for the torque values of the removed parts.

INSTALLATION

CAUTION

- To prevent burns, allow the engine, exhaust system, radiator, etc. to cool before installing the accessory.

NOTE:

- Take care not to damage the painted surfaces of the motorcycle.
- Save all removed parts unless otherwise indicated.

- Refer to the Service Manual for the motorcycle, remove the motorcycle parts.

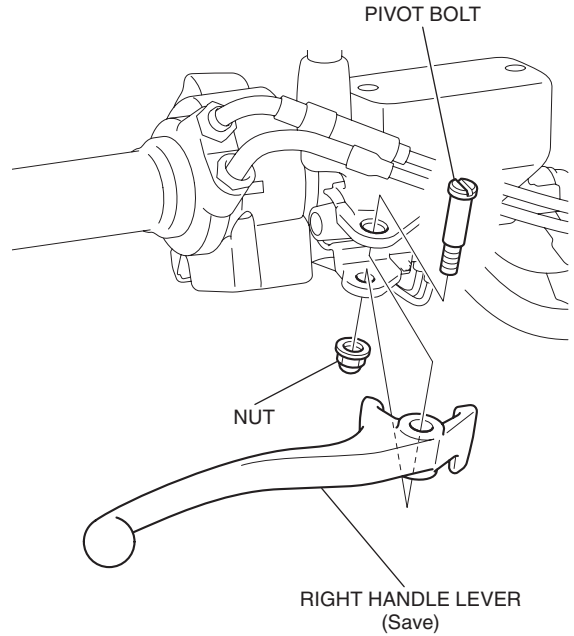

- Install the right handle lever assembly as shown.
 - Apply silicone grease to the pivot bolt sliding surface and master piston at the lever contacting area.

