

HONDA

INSTALLATION INSTRUCTIONS

Accessory

WINCH MOUNT KIT
P/N 08L70-HR6-MF0

Application

After '21 TRX420
After '21 TRX520

Publication No.

MII

Issue Date

June 2021

Honda Dealer: Please give a copy of these instructions to your customer.

PARTS LIST

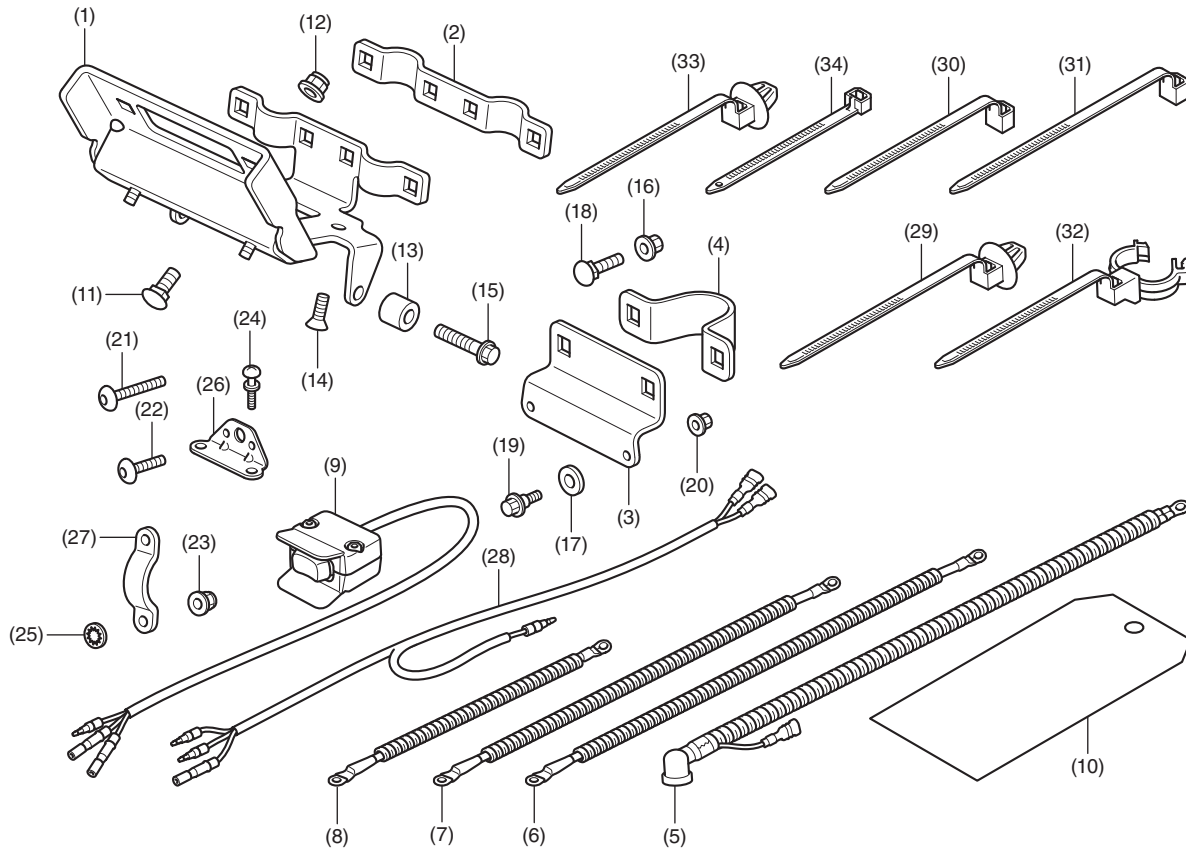

| No. | Description | Qty |
|------|----------------------------------|-----|
| (1) | Winch mount plate | 1 |
| (2) | Plate clamp | 1 |
| (3) | Contacter mount bracket | 1 |
| (4) | U-clamp | 1 |
| (5) | Cable, 8 ga. Black | 1 |
| (6) | Cable, 8 ga. Red | 1 |
| (7) | Cable, 8 ga. Blue | 1 |
| (8) | Cable, 8 ga. Yellow | 1 |
| (9) | Switch harness | 1 |
| (10) | Warning tag | 1 |
| (11) | 10 x 25 mm carriage bolt | 6 |
| (12) | 10 mm lock nut | 6 |
| (13) | Winch mount collar | 2 |
| (14) | 8 x 20 mm countersunk head screw | 4 |
| (15) | 8 x 35 mm flange bolt | 2 |
| (16) | 8 mm flange nut | 4 |
| (17) | Rubber washer | 2 |

| No. | Description | Qty |
|------|-----------------------------------|-----|
| (18) | 8 x 20 mm carriage bolt | 2 |
| (19) | 5 mm shoulder bolt | 2 |
| (20) | 5 mm flange nut | 2 |
| (21) | 5 x 25 mm socket bolt | 1 |
| (22) | 5 x 16 mm socket bolt | 1 |
| (23) | 5 mm lock nut | 2 |
| (24) | 6-32 x 1/4 inch Phillips screw | 2 |
| (25) | Locking tooth washer | 2 |
| (26) | Switch mount | 1 |
| (27) | Switch mount clamp | 2 |
| (28) | Winch sub-harness | 1 |
| (29) | Clip band A (W x L: 6 x 155.3 mm) | 5 |
| (30) | Wire tie A (W x L: 7 x 125 mm) | 1 |
| (31) | Wire tie B (W x L: 7 x 165 mm) | 1 |
| (32) | 17 mm tube clamp band | 1 |
| (33) | Clip band B (W x L: 5 x 110 mm) | 1 |
| (34) | Wire tie C (W x L: 8 x 129.5* mm) | 1 |

*: The length included the wire tie head.

WINCH

Sold separately P/N 08L71-HL5-E61

The Winch is required for the installation of this accessory.

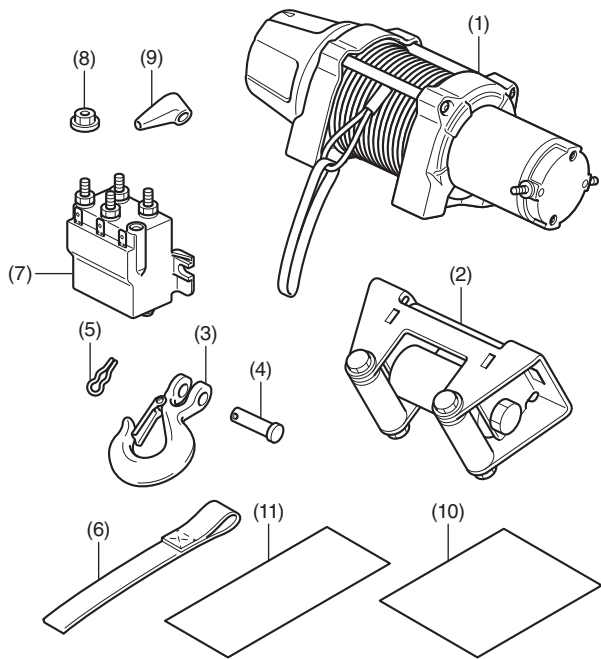

| No. | Description | Qty |
|------|----------------------------------|-----|
| (1) | Winch, VRX25 | 1 |
| (2) | Fairlead plow assembly, VRX2500 | 1 |
| (3) | HT Clevis slip hook, 5/16 | 1 |
| (4) | Clevis pin, 3125 | 1 |
| (5) | Cotter pin | 1 |
| (6) | Hook strap | 1 |
| (7) | Albright contactor, DC66-97P | 1 |
| (8) | 6 mm flange nut | 6 |
| (9) | Electric terminal boot, 6 ga. | 6 |
| (10) | Product literature, VRX and AXON | 1 |
| (11) | Declaration of conformity | 1 |

ACCESSORY SUB-HARNESS

Sold separately P/N 08Z00-HR3-A20

The Winch Mount Kit requires installation of the Accessory Sub-harness.

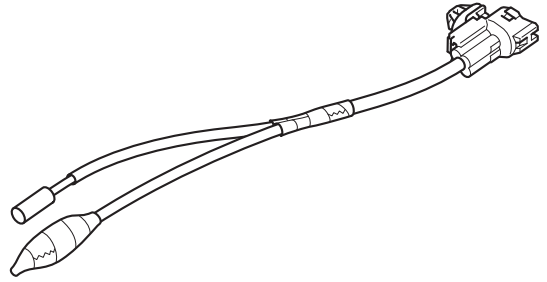

| Model | No. |
|------------------------------------|---------------|
| For model without accessory socket | 08Z00-HR3-A20 |

ACCESSORY SUB-HARNESS

Sold separately P/N 08Z01-HR3-A20

The Winch Mount Kit requires installation of the Accessory Sub-harness.

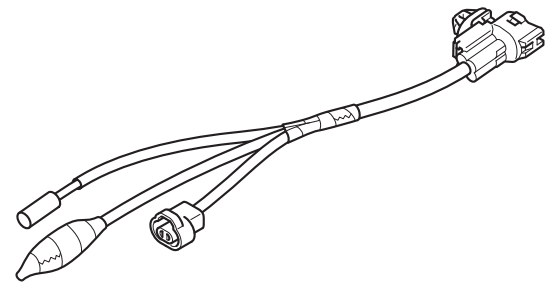

| Model | No. |
|---------------------------------|---------------|
| For model with accessory socket | 08Z01-HR3-A20 |

TOOLS AND SUPPLIES REQUIRED

Socket (8, 10, 12, 13, and 15 mm)

Ratchet

Hex wrench (3 and 5 mm)

Phillips® screwdriver

Trim clip puller #07AAC-SJAA-100

Torque wrench

TORQUE INFORMATION

Tighten all screws, bolts, and nuts to their specified torque values. Refer to the Service Manual for the torque values of the removed parts.

| Item | N-m | kgf-m | lbf-ft |
|---------------------------|-----|-------|--------|
| 5 mm socket bolt | 5.2 | 0.5 | 3.8 |
| 5 mm flange bolt and nut | 5.2 | 0.5 | 3.8 |
| 6 mm flange bolt and nut | 12 | 1.2 | 9 |
| 8 mm flange bolt and nut | 27 | 2.8 | 20 |
| 10 mm flange bolt and nut | 39 | 4.0 | 29 |

USE AND CARE INFORMATION

- Check the accessory mounts frequently and retighten if necessary.
- Replace this accessory with a new one if it is damaged or discolored excessively.
- Read through the instructions completely prior to installation of the winch kit.

INSTALLATION INFORMATION

▲ CAUTION

- To prevent burns, allow the engine, exhaust system, radiator, etc., to cool before installing the accessory.

NOTE:

- Take care not to damage the painted surfaces of the vehicle.
- Reinstall the removed parts on the vehicle and make sure that the wires and harnesses are not pinched.
- Disconnect the negative (-) cable from the battery before installing this accessory.
- After reconnecting the battery, refer to the vehicle Owner's Manual and reset the meter, if necessary.
- Trim the excess ends off the wire ties after attaching them to the wire harnesses. Do not allow the cut part of the wire tie to interfere with any harness or brake hose.
- After this accessory installation, check the lights (e.g. right / left turn signal lights and brake lights) for proper operation.

WINCH BRACKET INSTALLATION

NOTICE

- The 10 mm hardware included in this kit has two different thread pitches. Match the bolts with nuts before beginning installation to eliminate threading differently pitched hardware together. This will ensure a smooth installation.

1. Refer to the Service Manual for the vehicle, remove the engine guard.
2. Refer to the Service Manual for the vehicle, remove the tank cover assembly and front fender/carrier.
3. Refer to the Service Manual for the vehicle, remove the radiator grill right and center cover.

RADIATOR GRILL RIGHT AND CENTER COVER

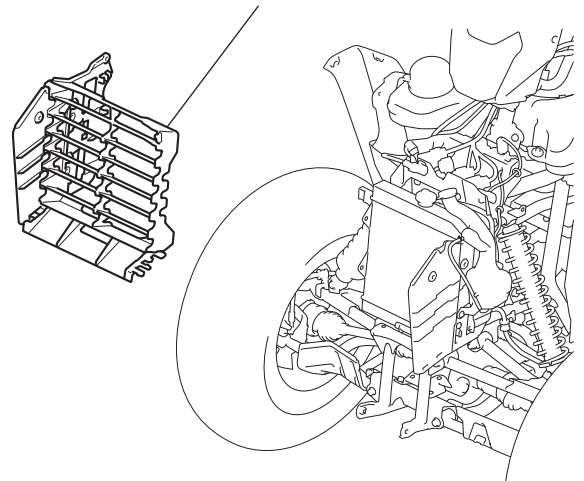

4. Install the fairlead plover assembly onto the winch mount plate using 10 x 25 mm carriage bolts and 10 mm lock nuts. Tighten the lock nuts to specification in the Torque Chart.

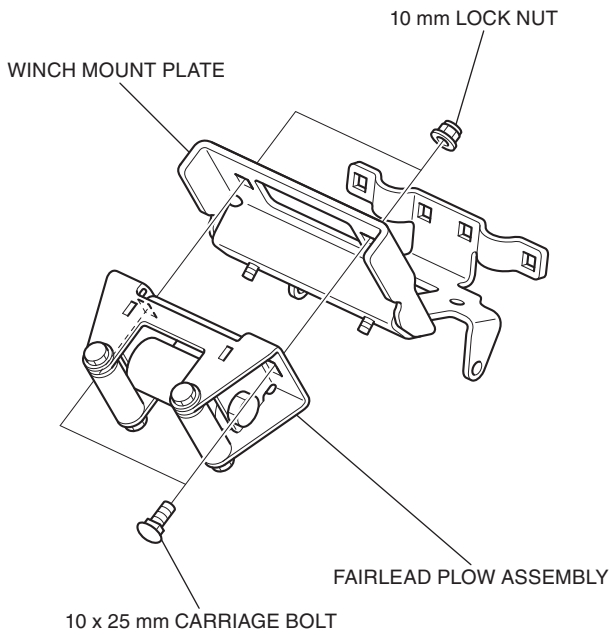

5. Install the assembled winch mount plate into the position shown and temporarily install the 8 x 35 mm flange bolts and winch mount collar as shown. Only hand tighten the bolts at this time.

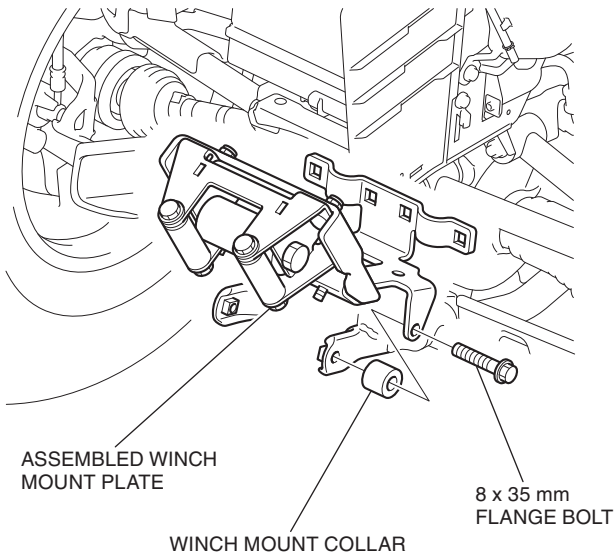

6. Install the plate clamp, 10 x 25 mm carriage bolts, and 10 mm lock nuts as shown. Tighten the lock nuts to the specification in the torque chart.

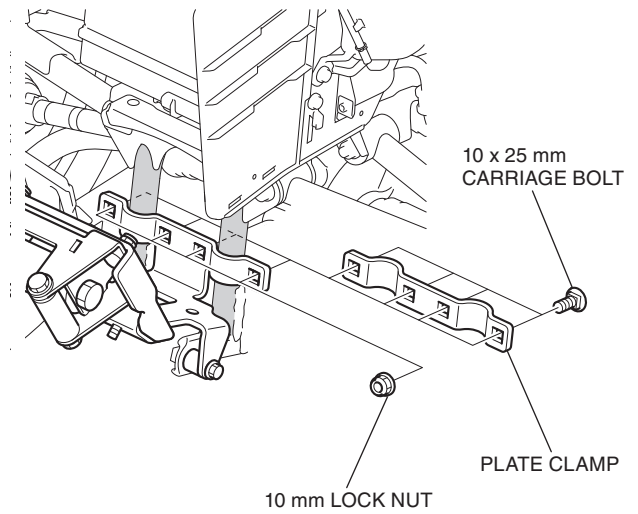

7. Place the winch into position on the assembled winch mount plate and secure it with the 8 x 20 mm countersunk head screws as shown. Tighten the screws to the specification in the Torque Chart.

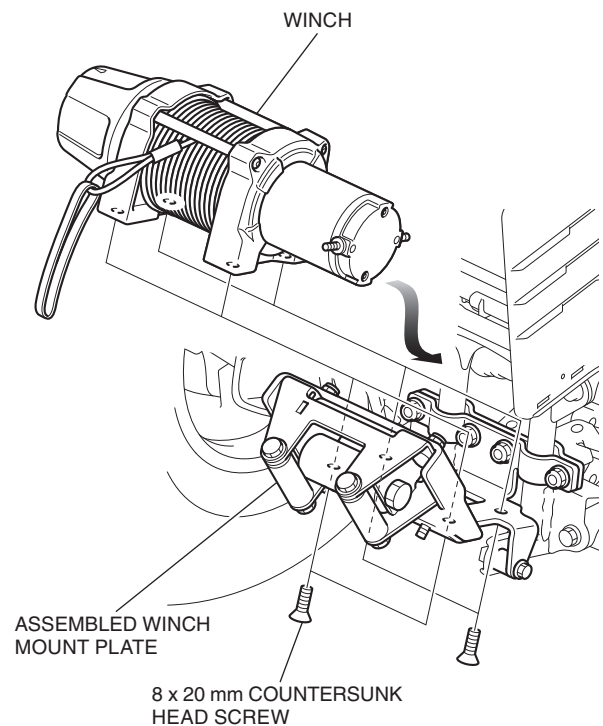

8. Feed the winch cable through the fairlead rollers as shown.
9. Proceed to ELECTRICAL INSTALLATION.

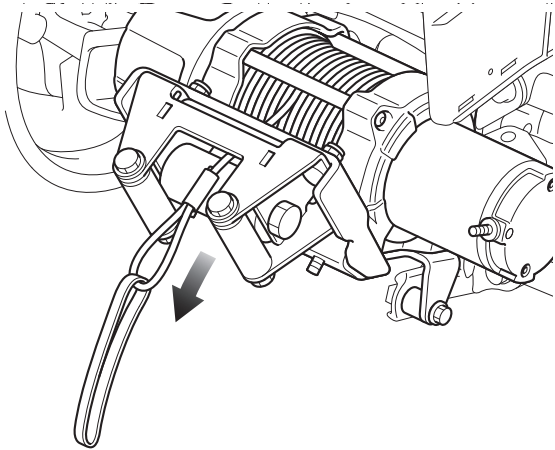

ELECTRICAL INSTALLATION

1. Refer to the Service Manual for the vehicle, remove the rear fender cover.

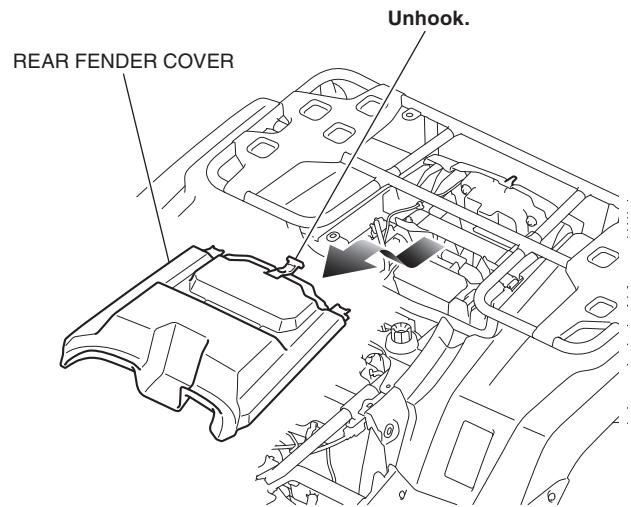

2. Refer to the Service Manual for the vehicle, disconnect the negative (-) cable from the battery.
3. Refer to the Service Manual for the vehicle, remove the handlebar cover or assist headlight.

HANDLEBAR COVER or ASSIST HEADLIGHT
(Depending on models)

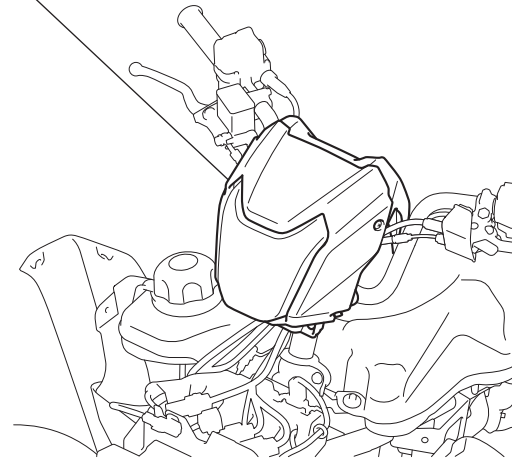

NOTE:

- Review the following instructions carefully before installing any electrical components.
4. Assemble and install the switch harness to the vehicle left handlebar and route the wire harness as shown. Tighten the screws to the specification in the Torque Chart.
- **Install the winch control switch at the same angle as the handlebar switch and at a position where it is easy to operation and do not interfere the vehicle operation.**

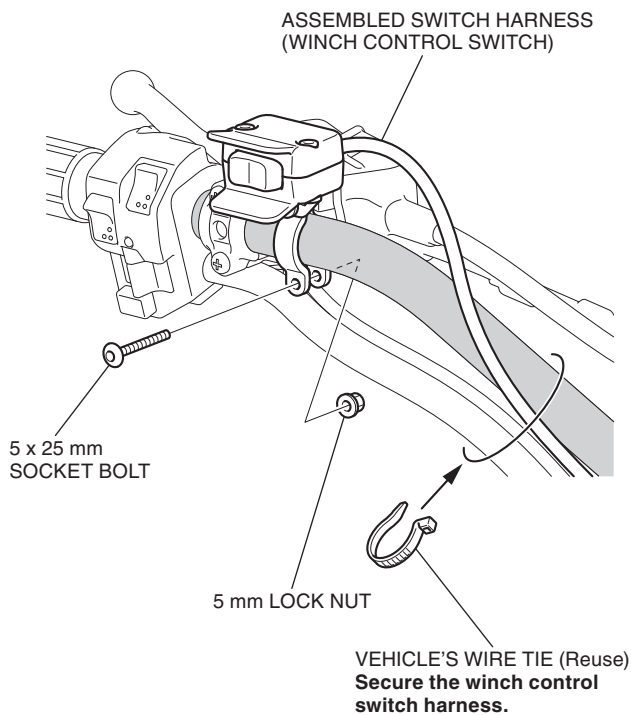
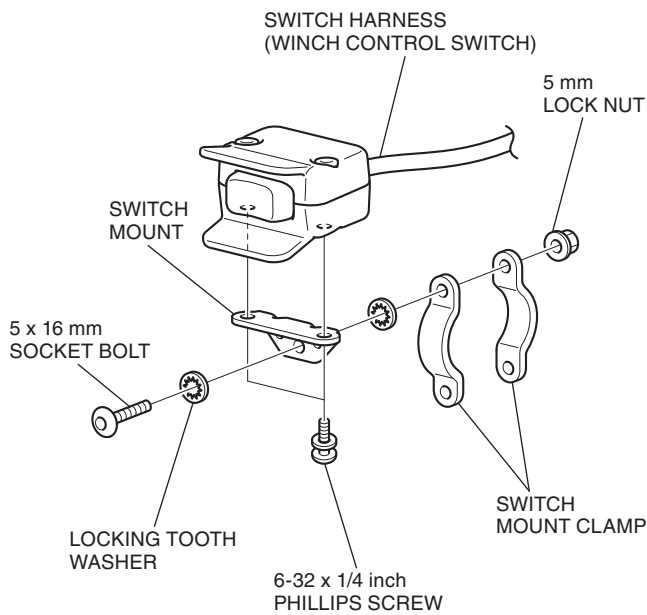

5. Install the albright contactor to the contactor mount bracket with the 5 mm shoulder bolts, rubber washers, and 5 mm flange nuts as shown.

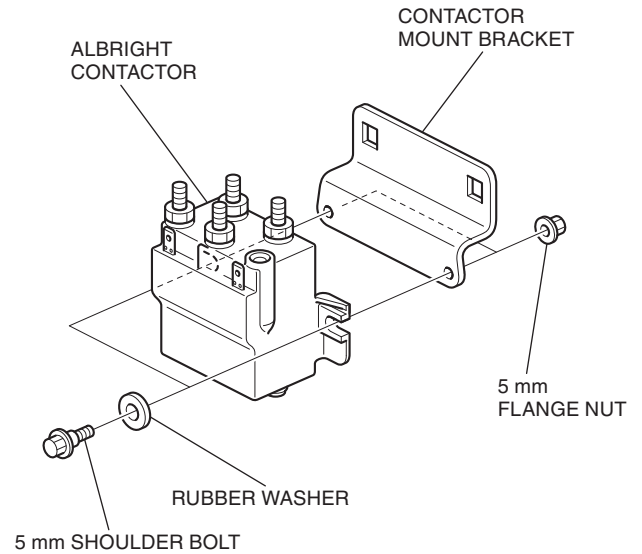

6. Loosely install the assembled contactor mount bracket and U-clamp to the left frame tube with the 8 x 20 mm carriage bolts and 8 mm flange nuts as shown. Adjust the position of the assembled contactor as necessary, then tighten the hardware to the specification in the Torque Chart.

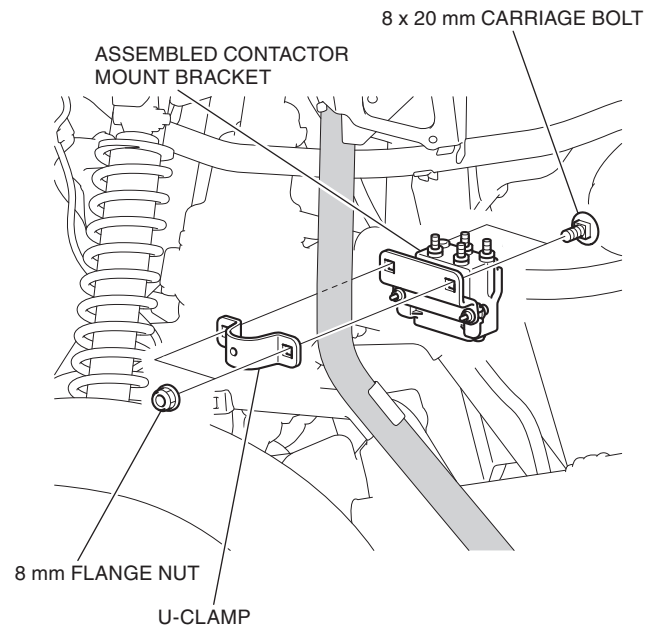

INSTALL THE ACCESSORY SUB-HARNESS (Sold separately.)

For Model without Accessory Socket:

1. Connect and route the winch sub-harness, Accessory Sub-harness, and switch harness as shown.
 - **Be sure to anchor the 4P (Red) connector to the vehicle as shown.**
 - **Connect the Red wire of the switch harness to the White/black wire of the winch sub-harness.**

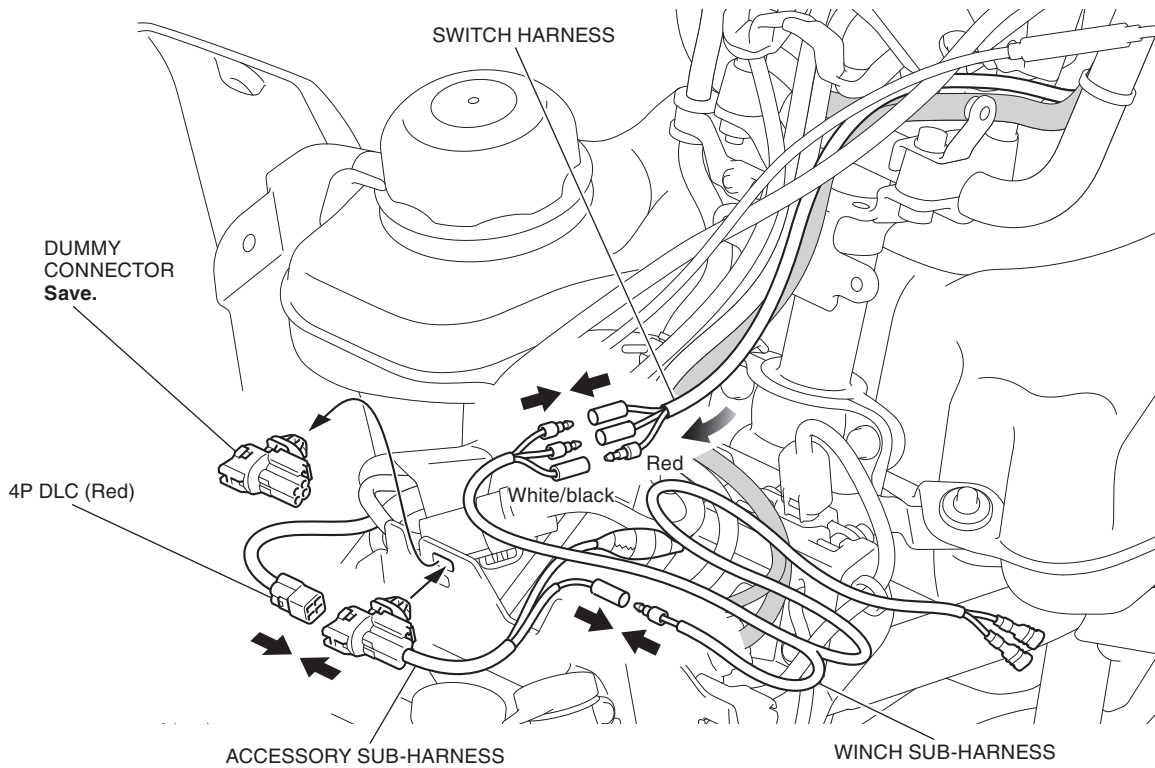

For Model with Accessory Socket:

1. Connect and route the winch sub-harness, Accessory Sub-harness, and switch harness as shown.
 - **Be sure to anchor the 4P (Red) connector to the vehicle as shown.**
 - **Connect the Red wire of the switch harness to the White/black wire of the winch sub-harness.**

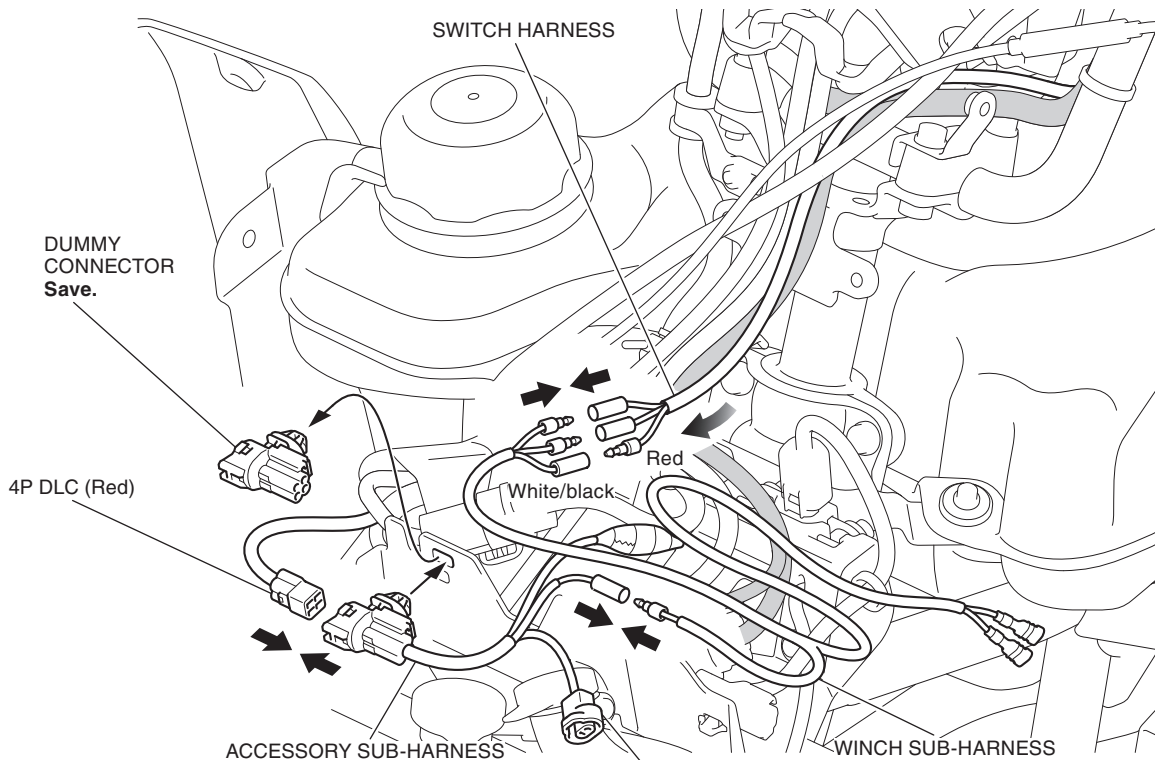

For Accessory Socket power supply connector

2. Route the winch sub-harness along the frame toward the contactor assembly.
Connect the Black and Green wires of the winch sub-harness to the corresponding color terminals of the contactor.

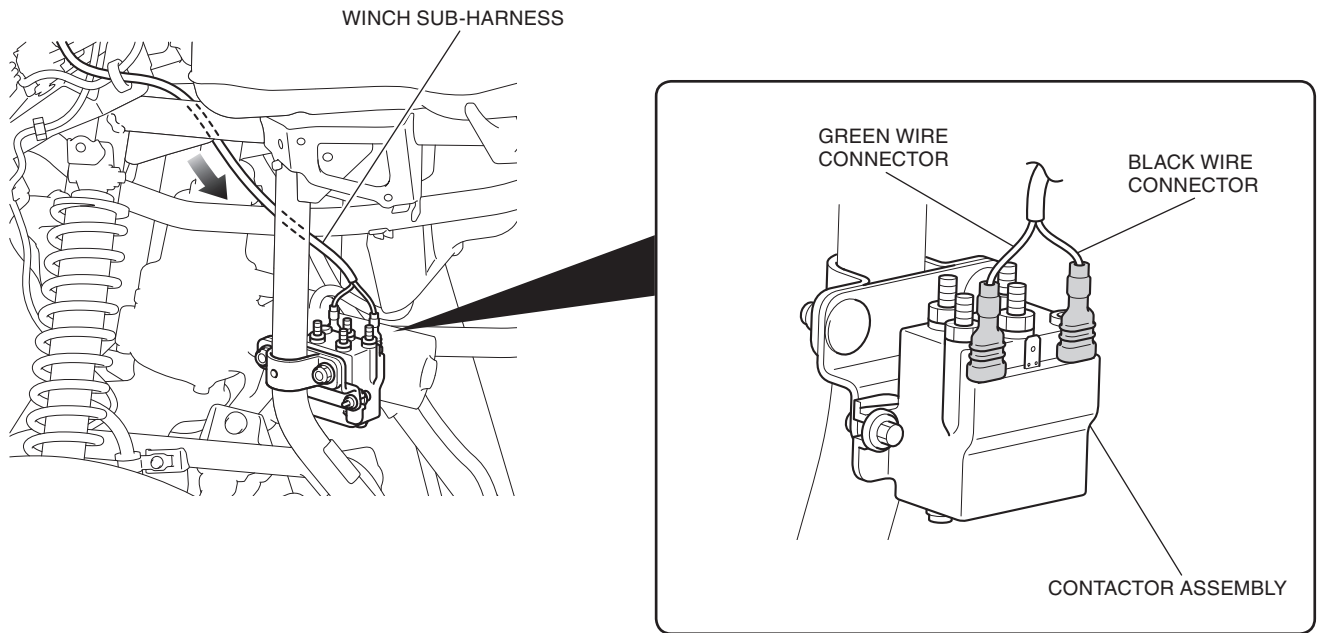

3. Bundle all the excess harness and secure it to the vehicle harness with wire tie(s) as necessary.
Check each harness for sufficient play.
- **Move the handlebar right and left, check that the harness are not pinched by the neighboring components and that they are not pulled taut.**

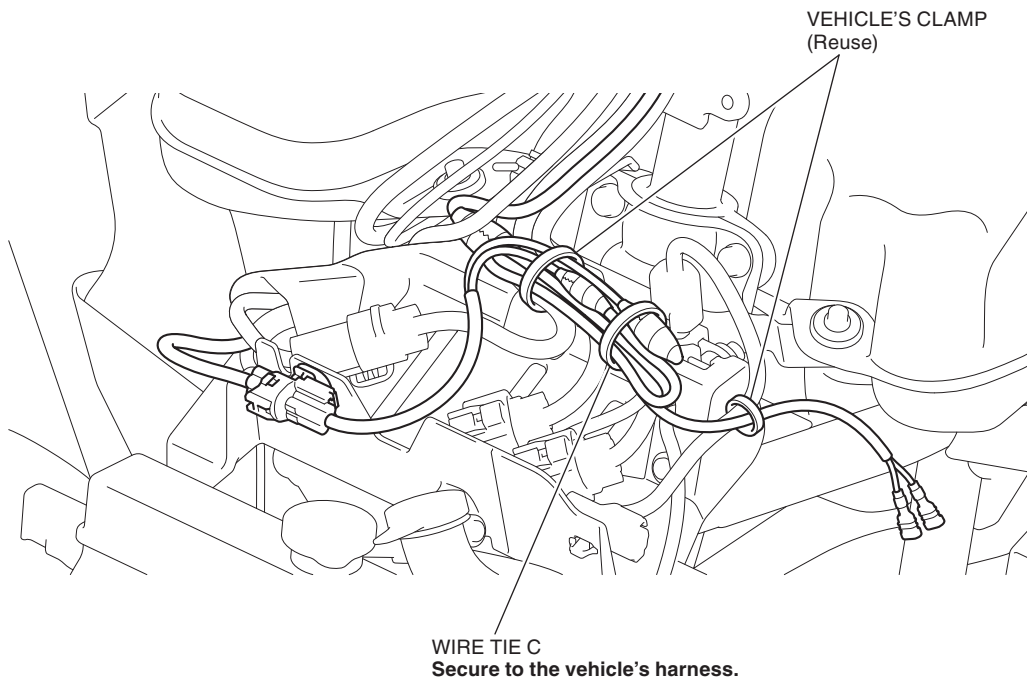

POWER AND GROUND CABLE CONNECTION

- The albright contactor and winch motor terminals are color coded. Be sure to install each cable to the correct color terminals.

1. Install the terminal boots to each end of the blue, yellow, and red cables.
 - **The black (ground) cable does not require terminal boots.**

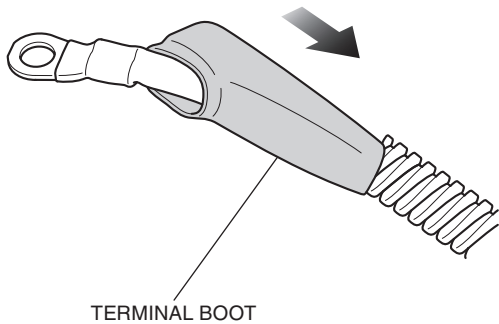

TERMINAL BOOT

2. Install the power and ground cables to their corresponding color contactor terminals with the 6 mm flange nuts.

Tighten the hardware to the specification in the Torque Chart.

Pull the terminal boots over the terminals.

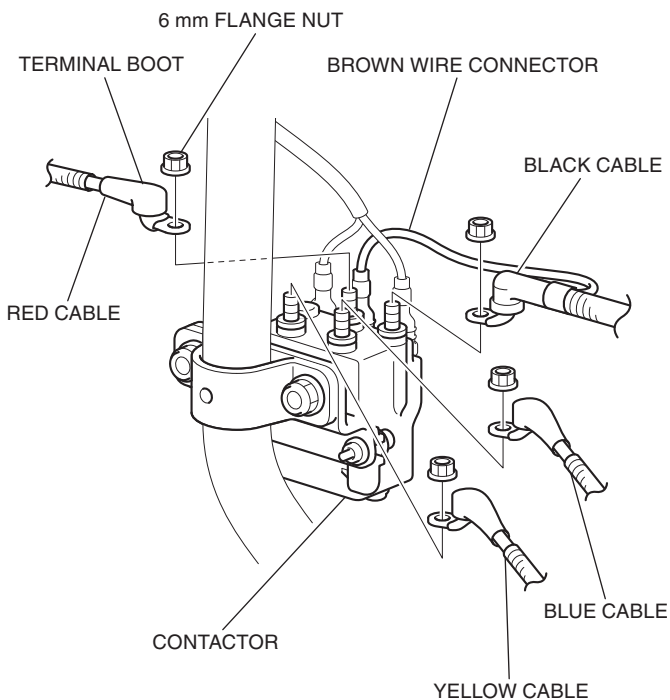

3. Route the blue and yellow cables forward along the frame rail toward the winch motor. Route the red and black cables up as shown. Secure the cables with the wire ties as shown.

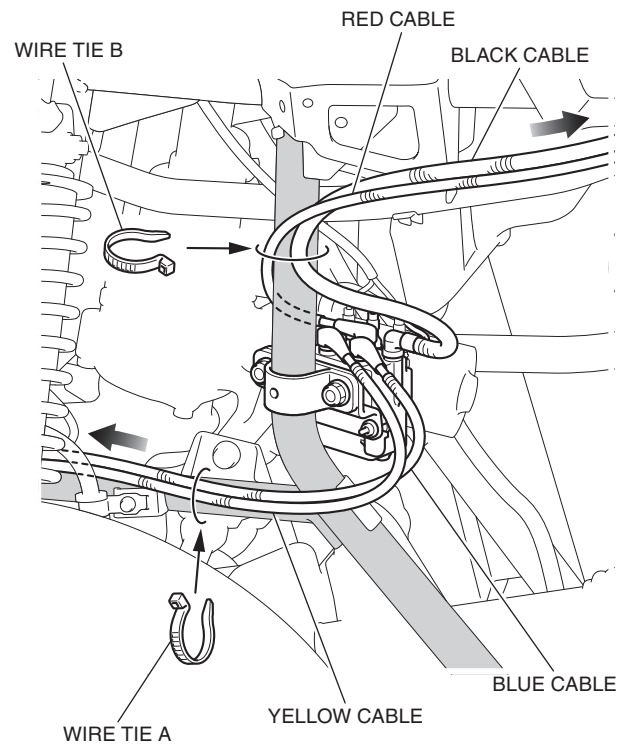

4. Route the red and black cables back toward the battery box as shown. Secure the cables with the 17 mm tube clamp band as shown.

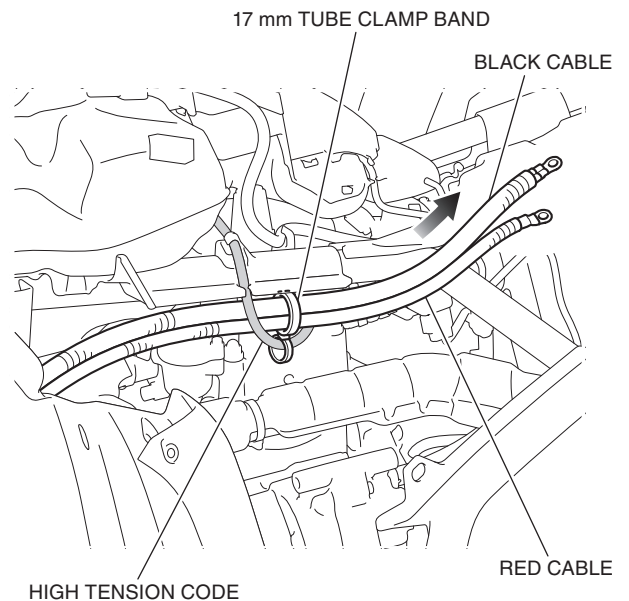

5. Connect the red cable to the terminal of the starter relay switch as shown. Tighten the nut securely and pull the terminal boot over the terminal. Route the black cable and install the clip band A as shown.

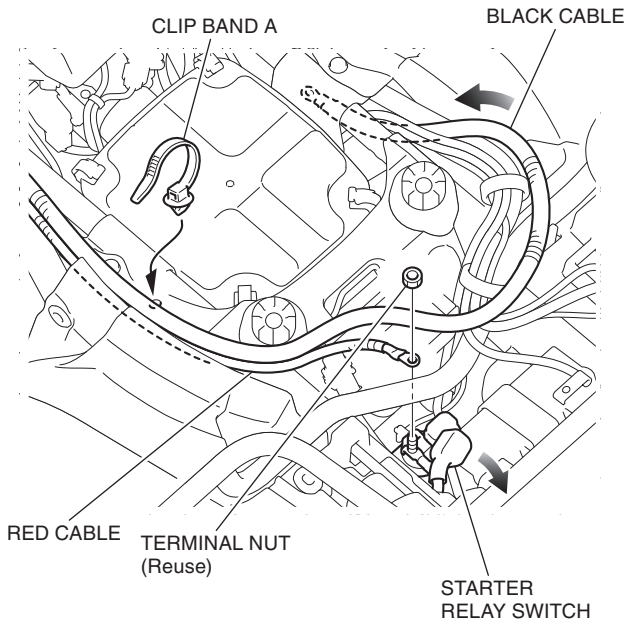

6. Connect the black (ground) cable to the chassis ground terminal as shown.

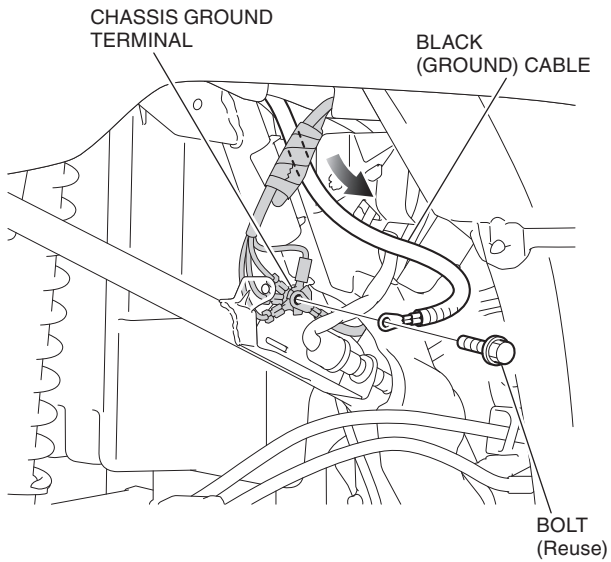

7. Secure the cables with the wire ties as shown.

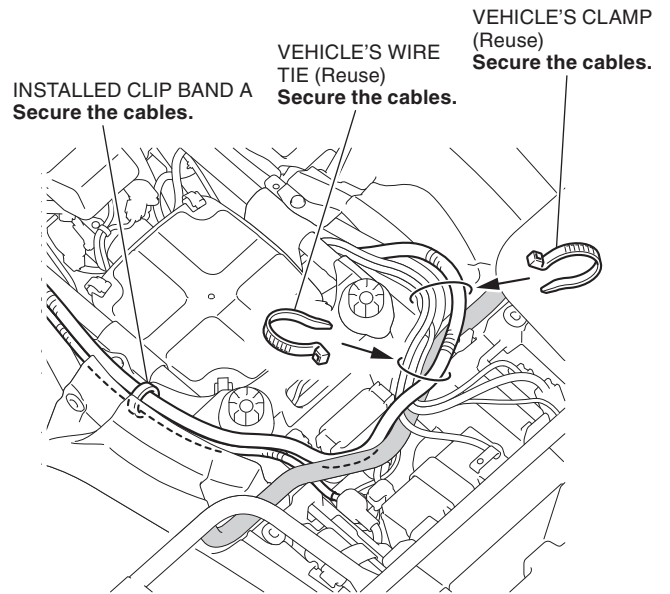

8. Connect winch blue and yellow cables to their corresponding color terminals on the winch motor with the 6 mm flange nuts as shown. Tighten the terminal nuts securely and pull the boots over the terminals.

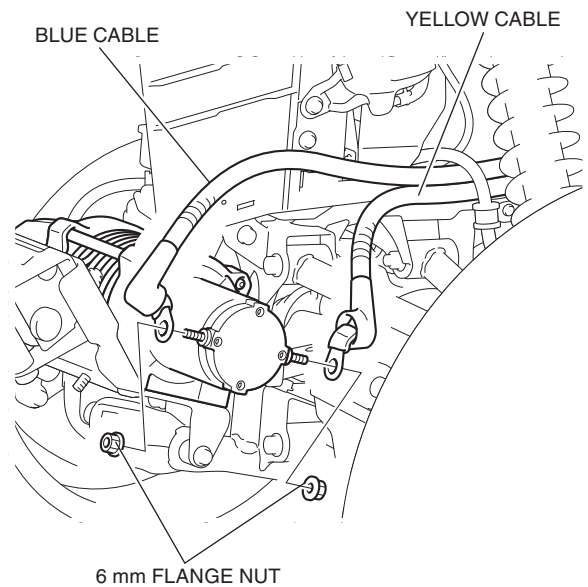

9. Reconnect the battery negative (-) cable.

CHECK THE SYSTEM

Before using the winch, verify the following:

- The wiring to all components is correct. All loose wires are secured tightly using wire tie(s).
- There are no exposed wiring or terminals (except the chassis ground bolt). Cover any existing terminal exposures with terminal boots, heat shrink tubing, or electrical tape.
- Turn the vehicle ignition switch to the ON position. Check the winch for proper operation. The wire rope should spool in and out in the direction indicated on the switch.

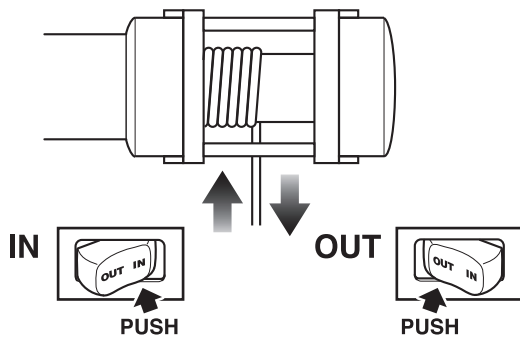

REINSTALL THE REMOVED PARTS

1. Remove the temporarily installed 8 x 35 mm flange bolts and winch mount collars from the winch bracket lower mount.

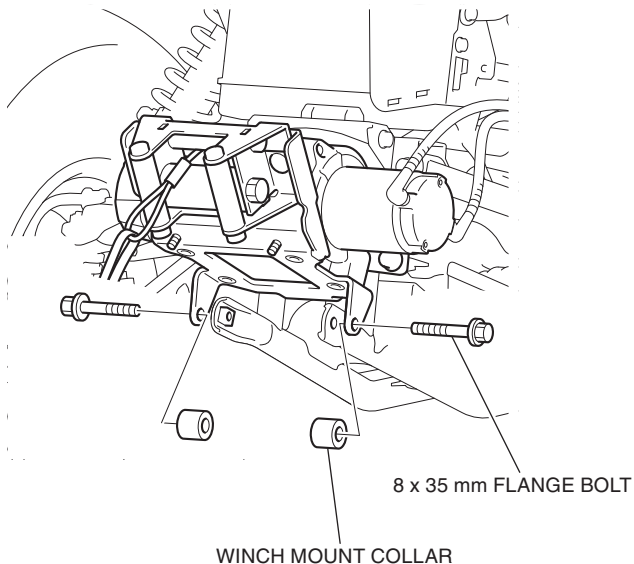

2. Refer to the Service Manual for the vehicle, reinstall the front carrier/fender assembly.
 - Still not be installed the radiator grill center and right cover.
 - Connect the headlights and accessory socket (if equipped) connectors.
3. Install the 8 mm flange nuts on the studs as shown.
 - Place a winch mount collar between the front carrier and winch mount plate as shown.
 - Install 8 x 35 mm flange bolts as shown.Tighten all hardware to the specification in the Torque Chart.

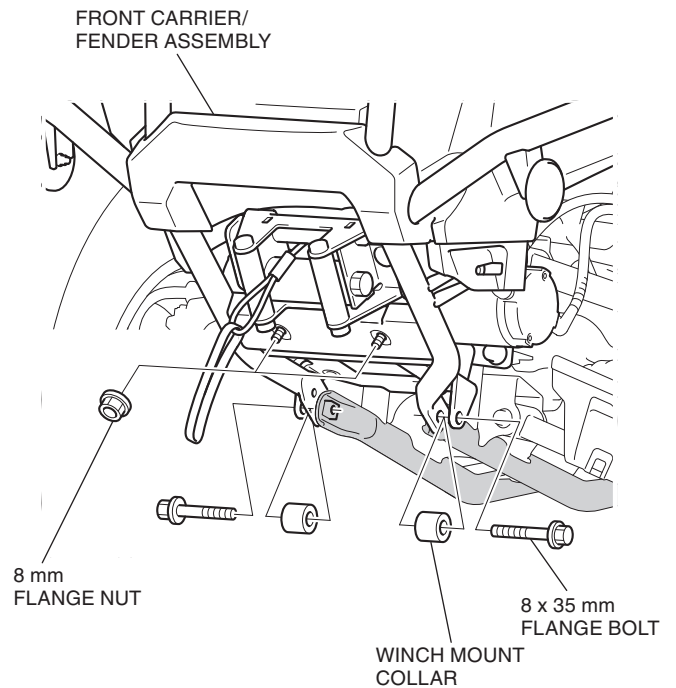

4. Reinstall the radiator grill right and center cover.

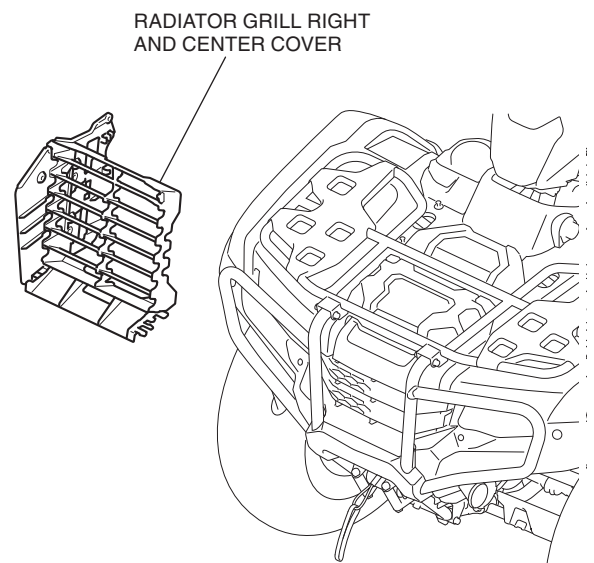

5. Install the removed parts.

6. Install the HT clevis slip hook with clevis pin and cotter pin using the instructions provided in the Warn Winch Motor package.
 - **Cut and discard the winch cable routed belt to install the HT clevis slip hook.**

